

Ref: ES162978

Price: 565,000€

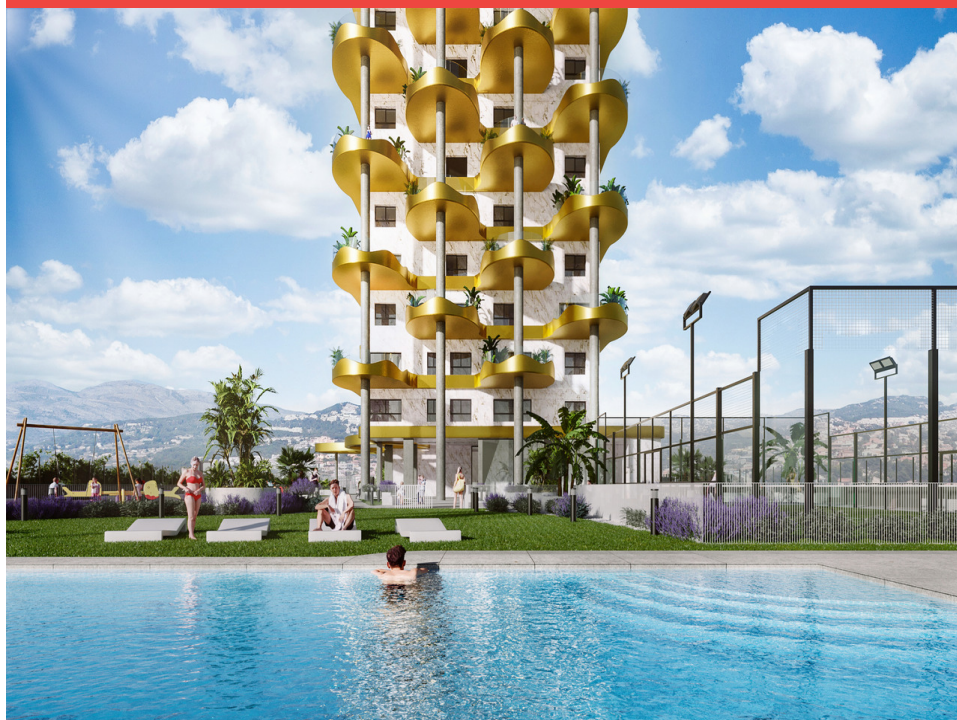

 **Apartment**

 **Calpe**

 **3**

 **2**

 **Pool: Yes**

This spectacular new building located in Calpe will offer its residents incredible views of the Rock of Calpe and the Mediterranean coast, thanks to its location very close to the sea and facing a green area that guarantees the owners of the apartments direct views .The building consists of 17 floors and only 32 apartments will be located on these floors.All these with 3 bedrooms and large terraces.Likewise, the common areas will be spacious and will allow residents to enjoy a community full of luxuries with common areas such as the large swimming pool, paddle tennis courts, gym, calisthenics ...(Ask for More Details!)





UK +44 333 022 0135

Email: info@1casa.com

Web: www.1casa.com

This spectacular new building located in Calpe will offer its residents incredible views of the Rock of Calpe and the Mediterranean coast, thanks to its location very close to the sea and facing a green area that guarantees the owners of the apartments direct views. The building consists of 17 floors and only 32 apartments will be located on these floors. All these with 3 bedrooms and large terraces. Likewise, the common areas will be spacious and will allow residents to enjoy a community full of luxuries with common areas such as the large swimming pool, paddle tennis courts, gym, calisthenics area and children's games. The building will have a parking area and storage rooms, included in the price of the apartment. The building will maintain an aesthetic in marbled white and gold colors, rising like a trunk with golden leaves, which will constitute the terraces of the apartments, allowing its owners to enjoy circular views. The apartments will be made of high-quality materials, including high-end appliances, air conditioning in all rooms, underfloor heating and electric shutters. In addition, different types of finishes are offered at the customer's choice. The apartments will have 3 bedrooms, their dimensions varying slightly between 113 and 125 square meters. Their terraces will be 30 to 40 square meters. The flats on the first and second floors are spread across the width of the building and have larger terraces.